

FFPC - Fidelux Flat Panel Series

Product Description

Fidelux FFPC series LED dimmable panels provide a simple 0-10v solution that is compatible with stand alone 0-10v dimmers as well as larger lighting control systems. Designed for drop in ceilings the FFP series panels are high performance and are the ideal energy-efficient replacement for fluorescent fixtures in office, schools, hospitality, healthcare, and other commercial and industrial applications. FFPC panels are available in 2'x2', and 2'x4' models in 3000k, 4000k, and 5000k correlated color temperatures.

Features & Benefits

- Ease of installation and low maintenance
- Factory Warranty 5 yrs
- Ultra-thin white profile - depth just 0.39"
- Sensor Options available
- Factory installed EM pack

Mounting Options

- Recessed T-Bar
- Suspension Kit
- Surface Mount
- Drywall Kit

Regulatory & Voluntary Qualifications

- UL, Damp location under covered ceiling, Indoor use only
- Most of our products are DLC listed, qualifying them for the highest rebates. Please check individual product specs for DLC status. Refer to DLC website by clicking this link: <https://www.designlights.org>



Performance Summary

Efficacy Up To: 117 l/pw

CRI: 80 cri

CCT: 30/35/40/50K

Dimming: 0-10v Dim Standard

Operating Temp: -25° - +55°C Ambient

Input Voltage: 100-277vac

Operating Frequency: 50 / 60Hz

Power Factor: 0.99

Dimension: 2x2, 2x4

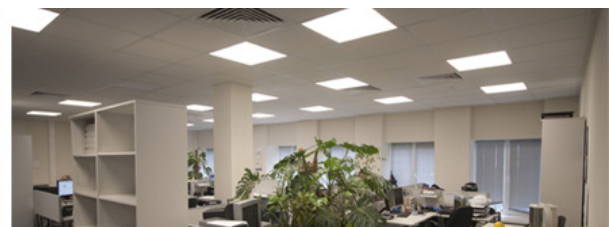
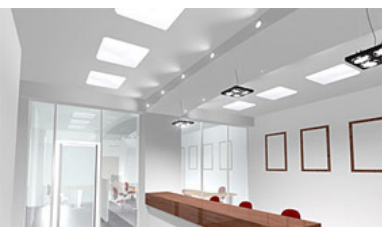

FFPC Series Specification Summary

DATA SOURCE	DLC	DLC	
Product Number	FFPC22-32W	FFPC24-38W	FFPC24-50W
Efficacy l/pw Nominal	117 l/pw	114 l/pw	116 l/pw
Input Power Watts@ 5000K	33.8	39.9	47.3
Lumens @ 3000K	3895	4464	5316
Lumens @ 3500K	3895	4464	5316
Lumens @ 4000K	3895	4464	5316
Lumens @ 5000K	3954	4550	5482
Qualifications	ETL, DLC 4.2 Damp location	ETL, DLC 4.2 Damp location	ETL, Damp location
CRI	83.6	83.2	82.7
CCT/Kelvin Temp Options	30/35/40/50K	30/35/40/50K	30/35/40/50K
Dimming	0-10V	0-10V	0-10V
Input Voltage Options	100-277vac	100-277vac	100-277vac
THD @ 120VAC	16.2%	17.7%	0.14%
Power Factor	0.99	0.99	0.93
L70 Lifespan	50,000 Hrs (TM21)	50,000 Hrs (TM21)	50,000 Hrs (TM21)
Beam/Field Angle	150°	150°	150°
Ambient Working Temp	-25°C to +55°C Ambient		
Max Dimensions (in)	23.74" x 23.74"	23.74" x 47.63"	
Total Weight	12lbs	24lbs	
Limited Warranty	5 Yrs.		

Notes

Values are nominal unless noted +/- 5%
Specifications change without notice

FFPC Series Product Ordering Guide

Example: FFPC24-38W-40K-UNV-D-EM15

Product	CCT/Color Temp	Voltage	Controls & Dimming	Emergency Backup
FFPC22-32W	30K (3000 Kelvin)	UNV (120-277V Std.)	D (0-10v Dimming) STD	Blank (No EM) EM15 (Emergency backup 15w-90min.)
FFPC24-38W	35K (3500 Kelvin)			
	40K (4000 Kelvin)			
FFPC24-50W	50K (5000 Kelvin)			

Factory Installed Options

EM15	15 Watt adjustable - 90 Min. Emergency Pack option
SC (set4)	Lay in Troffer/ Panel Support Clip <i>(order as separate line items)</i>

Field Installed Mounting Options *(order as separate line item)*

SUK22	2x2 Suspension Kit (4- hooks & aircraft cable with hardware)
SUK24	2x4 Suspension Kit (6- hooks & aircraft cable with hardware)
SMK22	2x2 Surface Mounting Kit - see mounting instructions sheet for details
SMK24	2x4 Surface Mounting Kit - see mounting instructions sheet for details
DWK22	2x2 Drywall Mounting Kit - consult factory
DWK24	2x4 Drywall Mounting Kit - consult factory

FFPC Series Design Details & Photometry

FFPC22 (2x2)

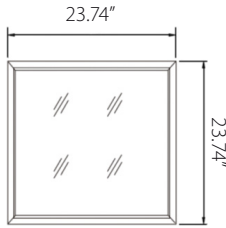

FFPC24 (2x4)

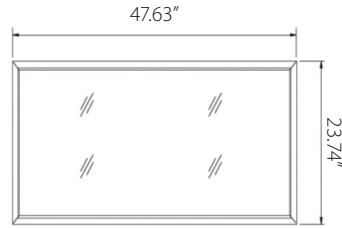

Photometry

FFPC22-32W-50K

Luminaire photometry has been conducted by a NVLAP accredited testing laboratory in accordance with IESNA LM-79-08. IESNA LM-79-08 specifies the entire luminance as the source resulting in a luminaire efficiency of 100%.

Zonal Lumen Density											
Y	Avg. I (CD)	Zonal F (LM)	Sum F (LM)	Eff Flux (%)	Eff Sum (%)	Y	Avg. I (CD)	Zonal F (LM)	Sum F (LM)	Eff Flux (%)	Eff Sum (%)
0	1339.874	0	0	0%	0%	95	0	4.850	3866.005	0%	100%
5	1333.832	31.963	31.963	.827%	.827%	100	0	0	3866.005	0%	100%
10	1316.660	94.816	126.780	2.453%	3.279%	105	0	0	3866.005	0%	100%
15	1286.927	154.443	281.223	3.995%	7.274%	110	0	0	3866.005	0%	100%
20	1246.699	208.806	490.029	5.401%	12.675%	115	0	0	3866.005	0%	100%
25	1196.296	256.225	746.254	6.628%	19.303%	120	0	0	3866.005	0%	100%
30	1134.763	294.997	1041.252	7.631%	26.934%	125	0	0	3866.005	0%	100%
35	1064.165	323.808	1365.059	8.376%	35.309%	130	0	0	3866.005	0%	100%
40	958.142	341.911	1706.971	8.844%	44.153%	135	0	0	3866.005	0%	100%
45	897.214	348.534	2055.504	9.015%	53.169%	140	0	0	3866.005	0%	100%
50	801.177	343.185	2398.689	8.877%	62.046%	145	0	0	3866.005	0%	100%
55	699.575	326.314	2725.002	8.441%	70.786%	150	0	0	3866.005	0%	100%
60	592.090	298.565	3023.567	7.723%	78.209%	155	0	0	3866.005	0%	100%
65	482.379	261.205	3284.772	6.756%	84.965%	160	0	0	3866.005	0%	100%
70	370.919	216.061	3500.833	5.589%	90.554%	165	0	0	3866.005	0%	100%
75	261.049	165.186	3666.019	4.273%	94.827%	170	0	0	3866.005	0%	100%
80	156.267	111.662	3777.681	2.888%	97.715%	175	0	0	3866.005	0%	100%
85	66.288	60.473	3838.155	1.564%	99.279%	180	0	0	3866.005	0%	100%
90	17.713	23	3866.005	.595%	99.874%						

Height	Average Lux (Lx)	Light Range (Dia.)
3'	654.3	10'
6'	180.1	20'
9'	80	30'
13'	45.1	40'
19'	19.9	60'

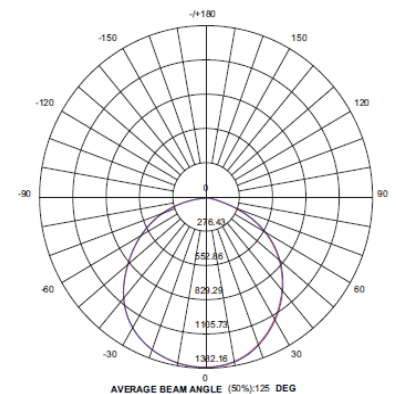
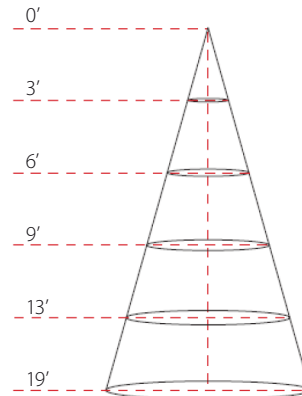

FFPC Series Installation Instructions

For all FFPC Series Flat Panel Product

Recessed T-Bar Mounting Kit

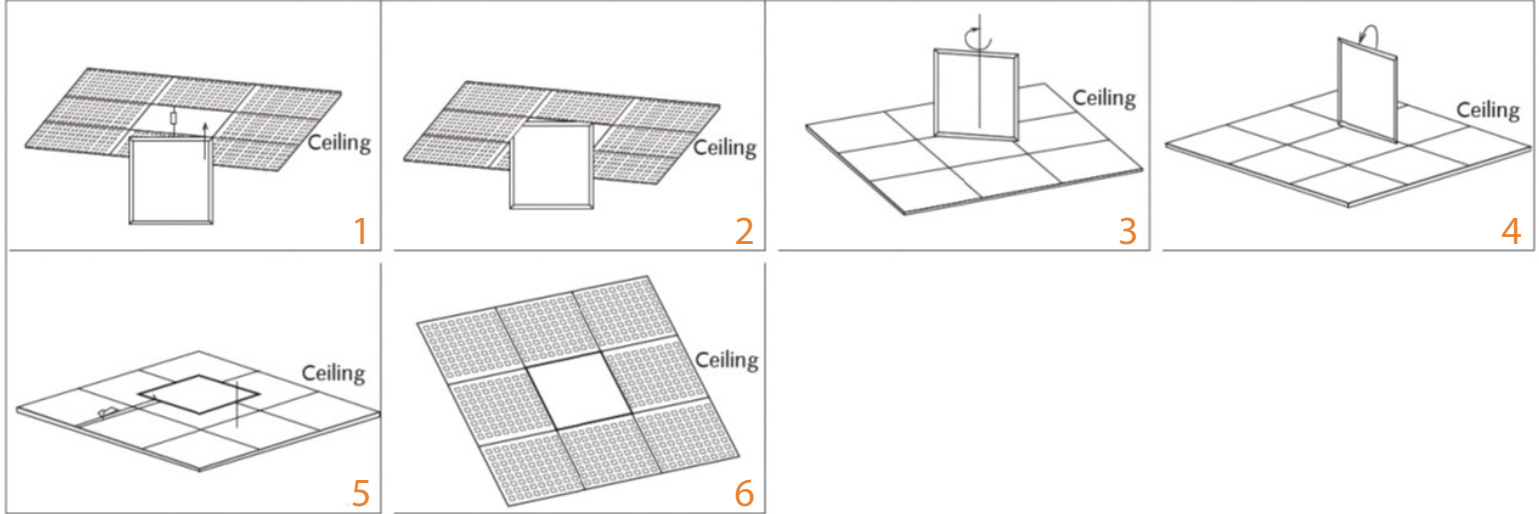

Suspension Kit with U-Hooks

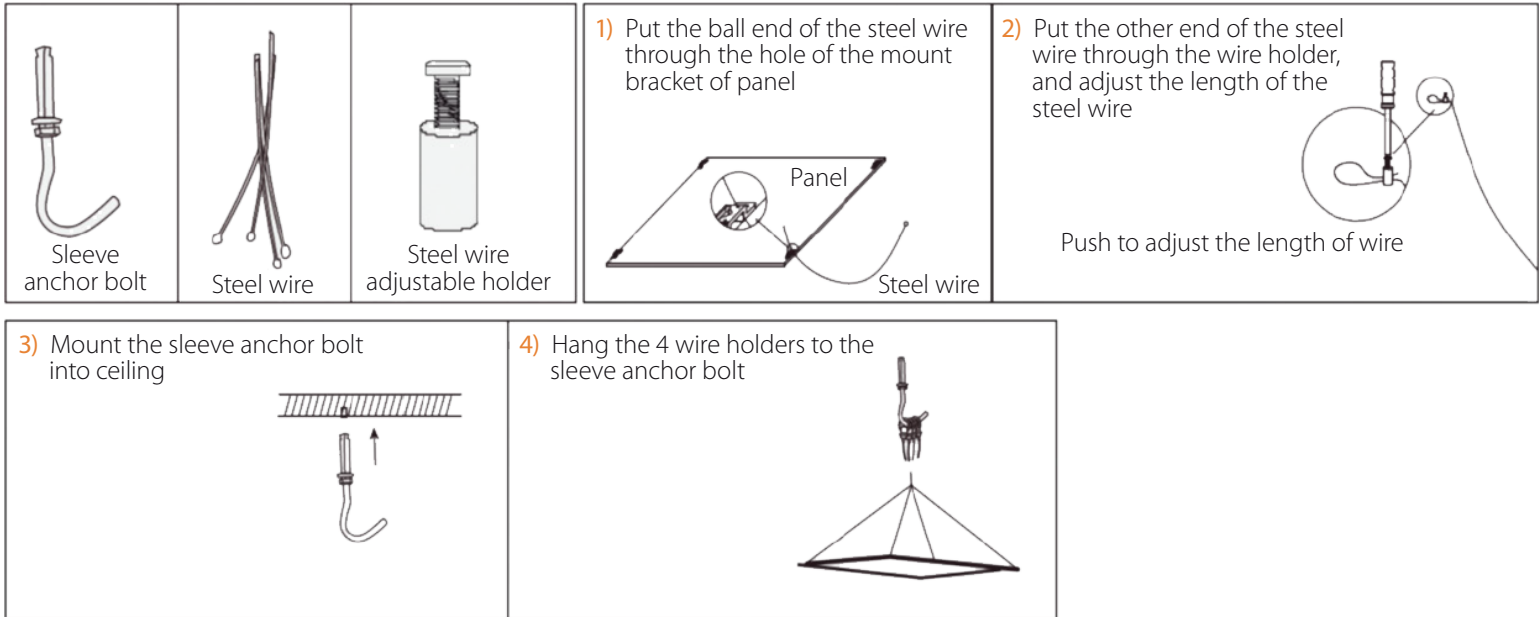

FFPC Series Installation Instructions

For all FFPC Series Flat Panel Product

Surface Mount Kit (ceiling)

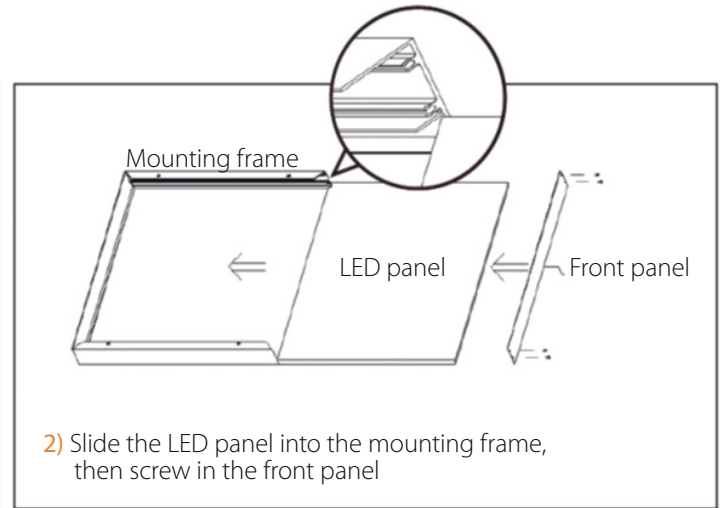
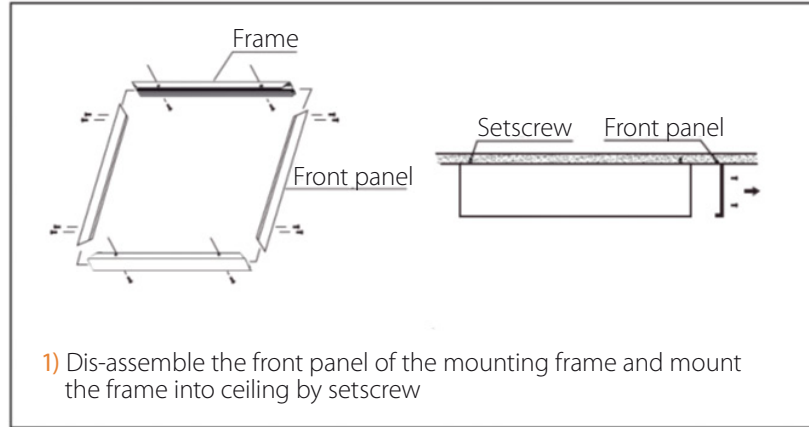

Wiring Diagram

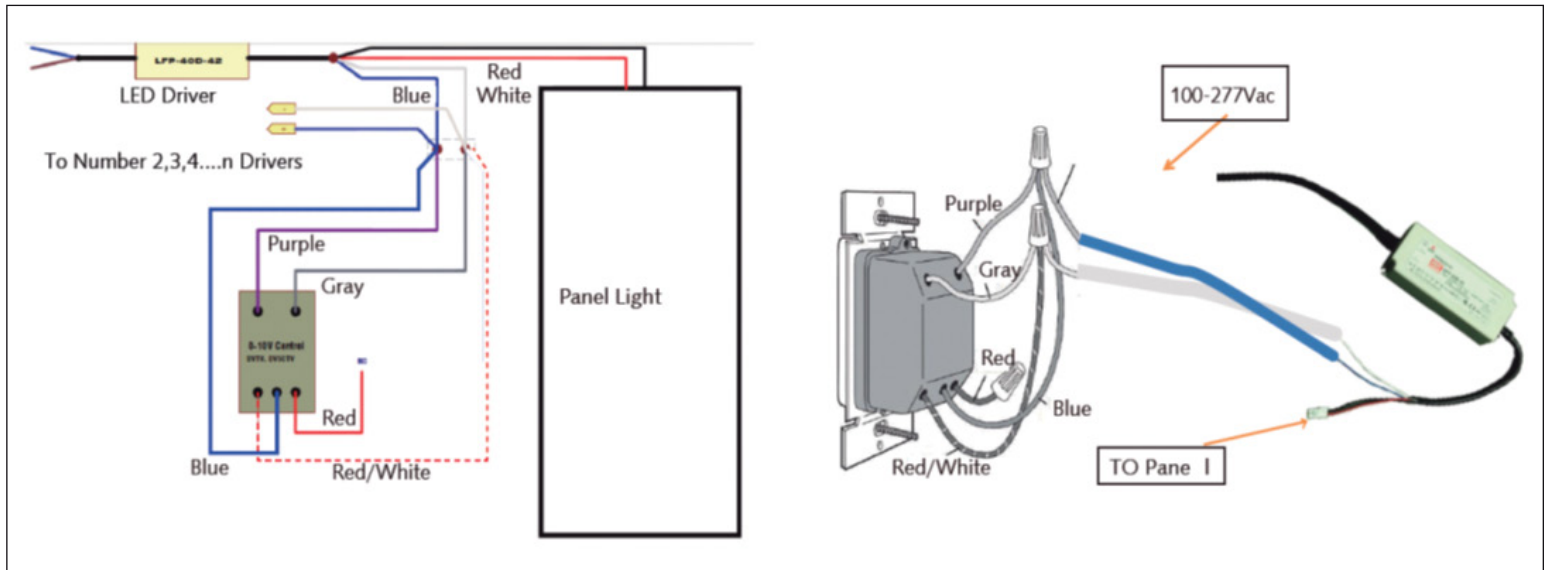

FFPC Series Installation Instructions

For all FFPC Series LED Strip/Stairwell Light Product

Drywall Mounting Kit (cut into drywall ceiling, wall, etc.)

WARNINGS:

Read and follow all safety instructions. Instructions must be shared and acknowledged by all persons providing installation services.

Installation and service of this product should be done by licensed and qualified electrical professionals. If you are not qualified, do not attempt installation. Contact a qualified electrician. This product is for indoor use only. Before installation or servicing turn off power supply at the circuit breaker or fuse box to avoid electric shock. At installation, ground the product if applicable. This product must be installed only in accordance with National Electrical Code or local electrical codes. Supplied power must be compliant with the voltage and frequency specified on the product label. Supplied power must be delivered to the fixture using plenum rated wire. Do not handle powered product with wet hands or when standing on wet area. To prevent wiring damage or abrasion, do not expose wiring to edges of sheet metal or other sharp objects. Save these instructions for future reference.

Surface Mount Installation

- 1) Turn off power supply at circuit breaker/fuse box.
- 2) Install surface mount housing to ceiling using 6 contractor supplied screws (see figure 1).
- 3) Check length of incoming power leads from ceiling. Leads should be long enough to reach fixture before install (>40' typ). Add additional length if necessary.
- 4) Remove J-box cover from fixture and open appropriate knock-out.
- 5) Route wire into J-box and secure as required by local codes.
- 6) Connect branch wires as shown in figure 2 - close J-box cover.
- 7) Connect branch wires, slide fixture into housing (see figure 3).
- 8) Install end cover and secure with 3 screws (supplied) (see figure 4).
- 9) Turn back on power supply at circuit breaker/fuse box.

Figure 1 (housing install)

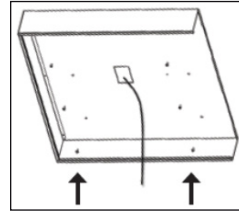

Figure 2 (electrical connections)

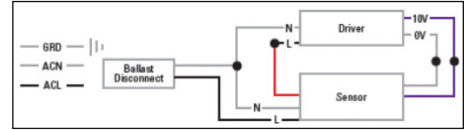

Figure 3 (fixture slide)

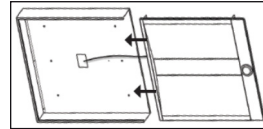
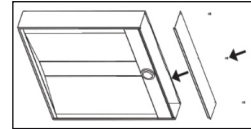

Figure 4 (end plate install)



Installation Order of Operation

- 1) Mount surface mount adapter to ceiling.
- 2) Route wiring through opening of adapter leaving long enough leads to make electrical connections.
- 3) Make electrical connections to the fixture.
- 4) Slide the fixture into the adapter.
- 5) Rotate the end plate into position.
- 6) Insert the fasteners through the end plate.

