

FFLD - Fidelux Flood Light Series

Product Description

Fidelux LED flood light series is a very versatile product. With an IP65 rating these fixtures are designed to be used outside. With the multiple wattage and lumen options these fixtures can be installed in many different applications. These fixtures would be ideal for car dealerships, youth sports parks, golf driving ranges, facades, parking lots, and general area illumination.

Features & Benefits

- IP65 rated
- Multiple lumen options
- High efficacy

Applications

- General outdoor illumination
- Parking Areas
- Stadium Lighting, Tennis Courts, Indoor & Outdoor Gymnasiums
- Corporate Landscape lighting

Mounting Options

- Yoke Mounting
- Trunnion Mounting
- Knuckle Mounting
- Slip Fit Mounting
- Wall Mounting

Regulatory & Voluntary Qualifications

- UL, Wet Location
- Most of our products are DLC listed, qualifying them for the highest rebates. Please check individual product specs for DLC status. Refer to DLC website by clicking this link: <https://www.designlights.org>



Performance Summary

Efficacy up to: 124 l/pw

CRI up to: 83 cri

CCT: 3000K / 4000K / 5000K

Dimming: 0-10vac & Non Dimmable

IP Rating: IP65

Operating Temp: -40 - +40C

Input Voltage: 100-277vac / 347-480vac / 50/60Hz

Power Factor up to: >0.94

NEMA BEAM Types: NEMA Flood Beam Spreads 5(H) x 6(V)
70-130 degree / Roadway: Type 2 Beam / Medium Cut Off



FFLD Series Specification Summary

DATA SOURCE		DLC	DLC	DLC	DLC	DLC	DLC	DLC
Product Number	FFLD-12W	FFLD-30W	FFLD-50W	FFLD-80W	FFLD-100W	FFLD-150W	FFLD-220W	FFLD-300W
Efficacy l/pw @ 5000K	119 l/pw	121 l/pw	121 l/pw	130 l/pw	124 l/pw	123 l/pw	122 l/pw	124 l/pw
Input Power: Watts	12	30	50	80	100	150	220	300
Lumens @ 3000K	1280	3131	5411	9600	11600	18600	26000	36600
Lumens @ 4000K	1362	3385	5870	9652	11667	18700	26800	37000
Lumens @ 5000K	1423	3538	6103	10142	12316	18752	26840	37200
CRI	82	82.5	82.7	83	83.2	82.3	83.5	82.4
THD @ 120VAC	11.31%	11.35%	16.09%	7.87%	9.14%	6.41%	7.95%	7.85%
CCT/Kelvin Temp Options	30/40/50	30/40/50	30/40/50	30/40/50	30/40/50	30/40/50	30/40/50	30/40/50
Nema Beam Type	6(H) x 6(V)	6(H) x 6(V)	6(H) x 6(V)	6(H) x 6(V)	6(H) x 6(V)	5(H) x 6(V)	5(H) x 6(V)	5(H) x 6(V)
Dimming	Non Dimming	Non Dimming	Non Dimming	0-10v	0-10v	0-10v	0-10v	0-10v
Input Voltage Options	100-277VAC	100-277VAC	100-277VAC	100-277VAC	100-277VAC	100-277VAC 347-480VAC (DLC Pending)	100-277VAC 347-480VAC (DLC Pending)	100-277VAC 347-480VAC (DLC Pending)
Qualifications	UL, DLC Pending, Wet Location	UL, DLC, Wet Location	UL, DLC, Wet Location	UL, DLC, Wet Location	UL, DLC, Wet Location	UL, DLC, Wet Location	UL, DLC, Wet Location	UL, DLC, Wet Location
Power Factor	>0.92	>0.90	>0.90	>0.90	>0.90	>0.93	>0.94	>0.93
L70 Lifespan	50,000+ hrs. (TM21)	50,000+ hrs. (TM21)	50,000+ hrs. (TM21)	50,000+ hrs. (TM21)	50,000+ hrs. (TM21)	50,000+ hrs. (TM21)	50,000+ hrs. (TM21)	50,000+ hrs. (TM21)
Ambient Working Temp	-40°C to +40°C	-40°C to +40°C	-40°C to +40°C	-40°C to +40°C	-40°C to +40°C	-40°C to +40°C	-40°C to +40°C	-40°C to +40°C
Max Dimensions (in)	4.3/4 x 3.1/4"	6.7/8" x 4.3/4"	8.5/8" x 6"	11" x 8.1/2"	11" x 8.1/2"	12.5/8"x11.3/4"	12.5/8" x 16.3/8"	12.5/8" x 16.3/8"
Total Weight	8-11lbs	8-11lbs	8-11lbs	11lbs - 15lbs	11lbs - 15lbs	11lbs - 15lbs	25lbs - 28lbs	25lbs - 28lbs
Limited Warranty	7 Yrs. with Option for 10 Yrs							

Notes

Values are nominal unless noted +/- 5%
Specifications change without notice

FFLD Series Product Ordering Guide

Example: FFLD-30W-30K-UNV-YK-BK

Product	CCT/Color Temp	Voltage	Controls & Dimming	Mounting Options	Finish
FFLD-12W (DLC Pending)	30K (3000 Kelvin)	UNV (120-277Vac/Non-Dim/STD)-Blank (12W,30W,50W)	PC-SF(NEMA style on/off Photocell) 150w-300w, with Slip Fitter Only	YK (Yoke Mount) All wattages	BK (Black)
FFLD-30W	40K (4000 Kelvin)			TR (Trunnion) 80w, 100w, 150w, 220w, 300w	BZ (Bronze) STD
FFLD-50W	50K (5000 Kelvin)	UNV (120-277Vac/0-10V Dim/STD) (80W, 100W, 150W, 220W, 300W)	PC (120-277v -External on/off Photocell installed in 1/2" KO)12w-300w except FFLD-50W-KN	KN (Threaded Nipple Type) 12w, 30w, 50w	WH (White)
FFLD-80W				SF (Slip Fitter Square),80w, 100w, 150w, 220w, 300w	
FFLD-100W		H (347-480Vac) 150w-300w only (DLC Pending)		WM (Wall Mount)* 150w, 220w, 300w	
FFLD-150W			PC-FI(120-277v - Factory Wired Photo Cell) 12w-300w except FFLD-50W-KN	FRB3-1 (3 in 1 Slip Fitter Adapter) 80w-300w, order separate Line item	
FFLD-220W					
FFLD-300W					

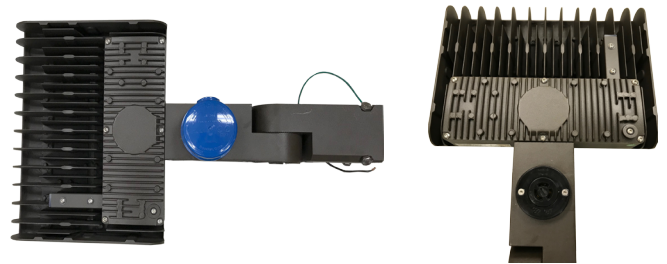

Factory Installed Options

YK	Yoke mount - standard on all wattages
TR	Trunnion mount - 80w, 100w, 150w, 220w, 300w
KN	Threaded nipple - 12w, 30w, & 50w
SF	Slip fit mount - 80w, 100w, 150w, 220w, 300w
WM	Wall mount plate - 150w, 220w, 300w

Factory Installed Options

1 - 0-10v Option (only available for 80w-300w Floods)

1. 18ga wire only included from factory when using a Slip Fitter Mounting option
2. All other Mounting options the 18ga 2wire will need to be provided by installer.

2 - 0- 10v Installation Instructions

1. Remove Back Plate that houses the driver (See Red Arrow)
2. Find Violet & Grey 0-10v wires
3. Splice the 18ga wire + / - and run wire through 1/2 KO using weatherproof 1/2" connector
4. Best practice is to limit the distance run for the analog control wiring from the controller to the last driver to 300ft, 400ft using 16ga

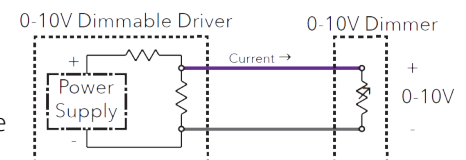
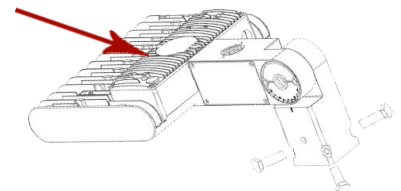

FFLD Series Design Details & Photometry

12W

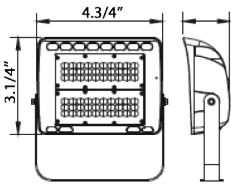

30W

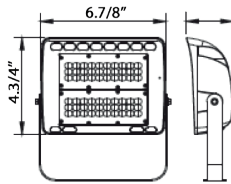

50W

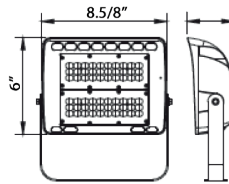

80W & 100W

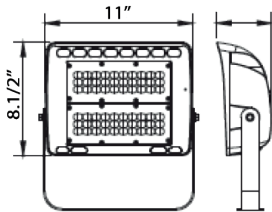



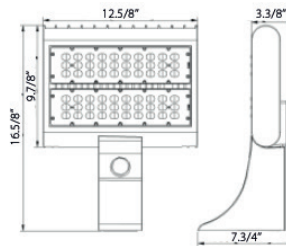

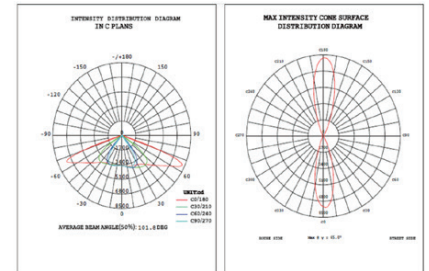

150W



220W & 300W



EPA (Effective Projected Area)

Configuration						
	1	2@180°	2@90°	3@90°	3@120°	4@90°
F8-6-*** W ~ 88-6-100W,						
EPA (Sq. Ft.)	0.51	1.02	0.91	1.42	1.65	1.65
Weight (Lbs.)	6.05	12.10	12.1	18.15	18.15	24.20
88-6-110 W ~ F8-6-220W, F8-6-300W						
EPA (Sq. Ft.)	0.55	1.10	0.95	1.50	1.74	1.74
Weight (Lbs.)	8.50	17.00	17.00	25.50	25.50	34.00

B.U.G Rating

System Watts	Dist. Type	Lumens	Lpw	B	U	G
80-100W	Type III	9600 lm-11600lm	121 l/pw	3	1	2
150w	Type III	18600 lm**	124 l/pw	3	1	3
220w	Type III	26700 lm**	123 l/pw	4	2	5
300w	Type III	37000 lm**	124 l/pw	4	2	5

FFLD Series Installation Instructions

For all FFLD Flood Lights

Introduction

This LED Wall-Packs light uses the latest in solid state lighting technology for long life, low maintenance, and high efficiency. The same as traditional HID lighting, it could be mounted with a standard photocell on the enclosure, to make it completely suitable for street lighting. An internal power-factor-corrected switch-mode supply allows it to be used from any nominal 100V-277V, 60Hz AC supply without any variation in light output.

Installation

Warning: To avoid the risk of fire, explosion, or electric shock, this product should be installed, inspected, and maintained by a qualified electrician only, in accordance with all applicable electrical codes.

To avoid electric shock:

- Be certain electrical power is OFF before and during installation and maintenance.
- Luminaire must be connected to a wiring system with an equipment-grounding conductor.

To avoid explosion:

- Make sure the supply voltage is the same as the rated luminaire voltage.
- Do not install where marked operating temperatures exceed the ignition temperature of the hazardous atmosphere.
- Do not operate in ambient temperatures above those indicated on the luminaire.
- Keep lens tightly closed when in operation.

CAUTION: Risk of shock and disconnect power before servicing.

For supply connections use wire rated for at least 90°C.

Installation Steps:

Refer to the following diagram when you install the fixture. Seven installation methods, directly fix to the mounting surface or fix to a post with a knuckle.

Directly fix to mounting surface

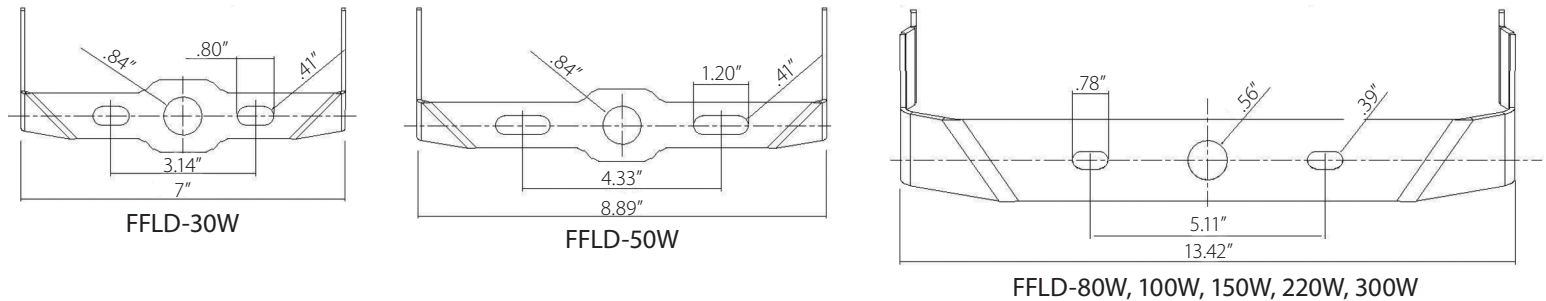

- 1) Use expansion bolts to secure the fixture to a mounting surface.
- 2) Keep enough length wires to ensure adjusting angle unhindered.
- 3) Connect wires into wiring terminal: white wire to "neutral" terminal, black wire to "live" terminal, green wire to "ground" terminal; and fix them by screws.

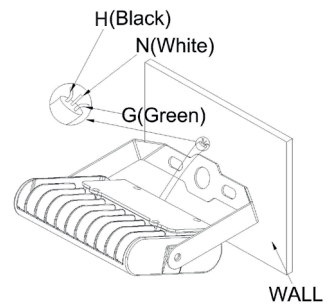

FFLD Series Installation Instructions

For all FFLD Flood Lights

Mounting with a knuckle for models: FFLD-12W-50W

- 1) Secure service wire or conduit to the wiring compartment cover with 1/2" connector (not provided). Connect white fixture wire to white supply wire, black fixture wire to black supply wire. Service ground should be attached to green ground screw provided. Ground must be properly attached to avoid the risk of electrical shock. Use wire nuts, crimp-on lugs, or other approved devices to connect all wires, make sure connections are secure and that no loose wire strands are sticking out of connectors, secure wiring compartment cover to fixture. With black and white connections inside the wiring compartment. Use UL and cUL listed flexible steel waterproof conduit in trade sizes 1/2 and UL and cUL listed water-proof outlet box cover.

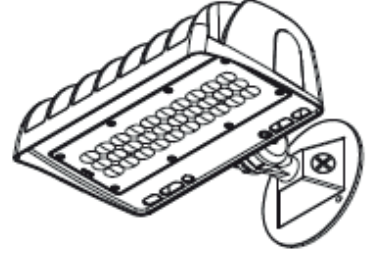

Mounting with a with a Slip Fitter for models: FFLD-150W, 220W & 300W

- 1) Adjust the fixture orientation by turning the bolt. In the right photo for the rocker installation hole, for the sensor installation hole in the bottom.
- 2) Slip Fitter to existing Round Pole. - The Pole should be no bigger than an Outside Diameter of 2-3/8". You can open the side cover from the side connection.

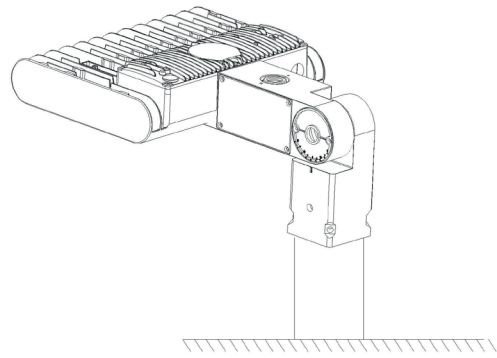
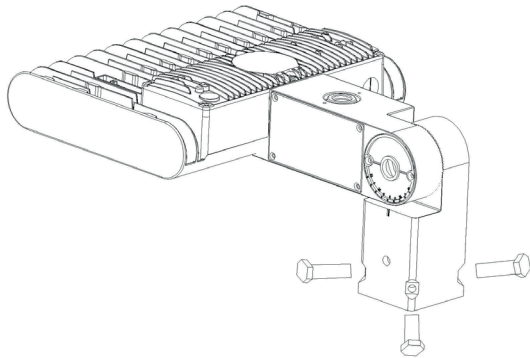

Mounting with a trunnion for models: FFLD-80W-100W, 150W, 220W, & 300W

- 1) Please drill holes on the square pole according to the size above W.
- 2) Adjust the fixture to an oposite orientation, tighten the screws.

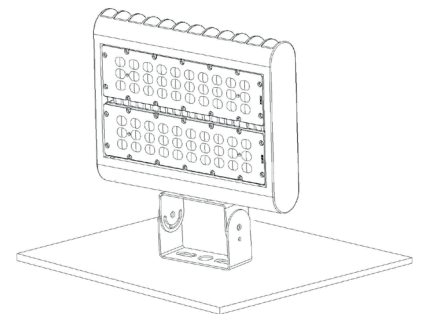

FFLD Series Installation Instructions

For all FFLD Flood Lights

Lifting method of mining lamp for models: FFLD-150W, 220W & 300W

- 1) Use 2 aircraft cables and attach to each side of fixture radiator and then hang lamp.

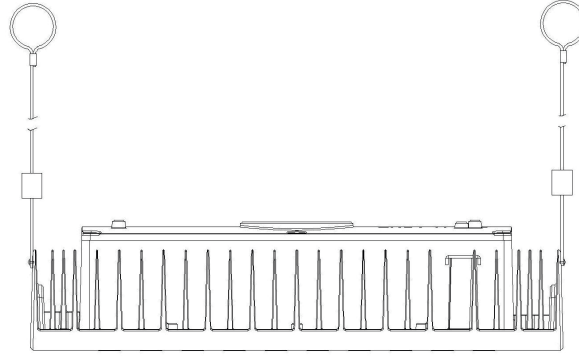

(WM) Wall mount / Straight Arm for models: FFLD-150W, 220W & 300W

- 1) Bolt wall mount to the lamp post through the access plate by taking off 4 screws that hold cover. Example in the photo to right
- 2) Reserved light installation knock outs for sensor a installation hole in the bottom. You can open the side cover from the side connection.

After Installation, Please:

- Check whether the lighting fixture is firmly fixed to wall.
- Check whether wires are connected correctly.

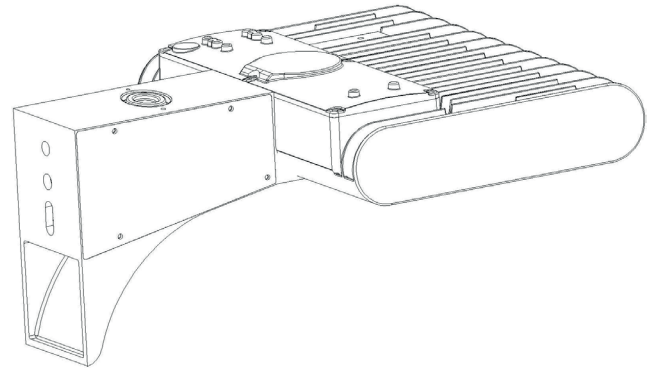

Mounting Options for Fidelux FFLD Series Flood Lights

FFLD-12w, 30w & 50w

Yoke



Knuckle / Threaded nipple



FFLD-80w & 100w

Yoke



Trunnion



Slip Fitter / NO NEMA

FFLD-150w, 220w & 300w

Yoke



Trunnion



Slip Fitter Square/ With NEMA



USEFUL ADAPTORS

FRB3-1



Slipfitter adaptor

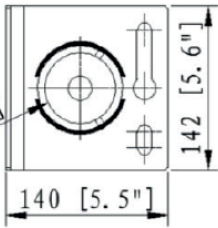
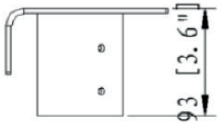

Dimension